

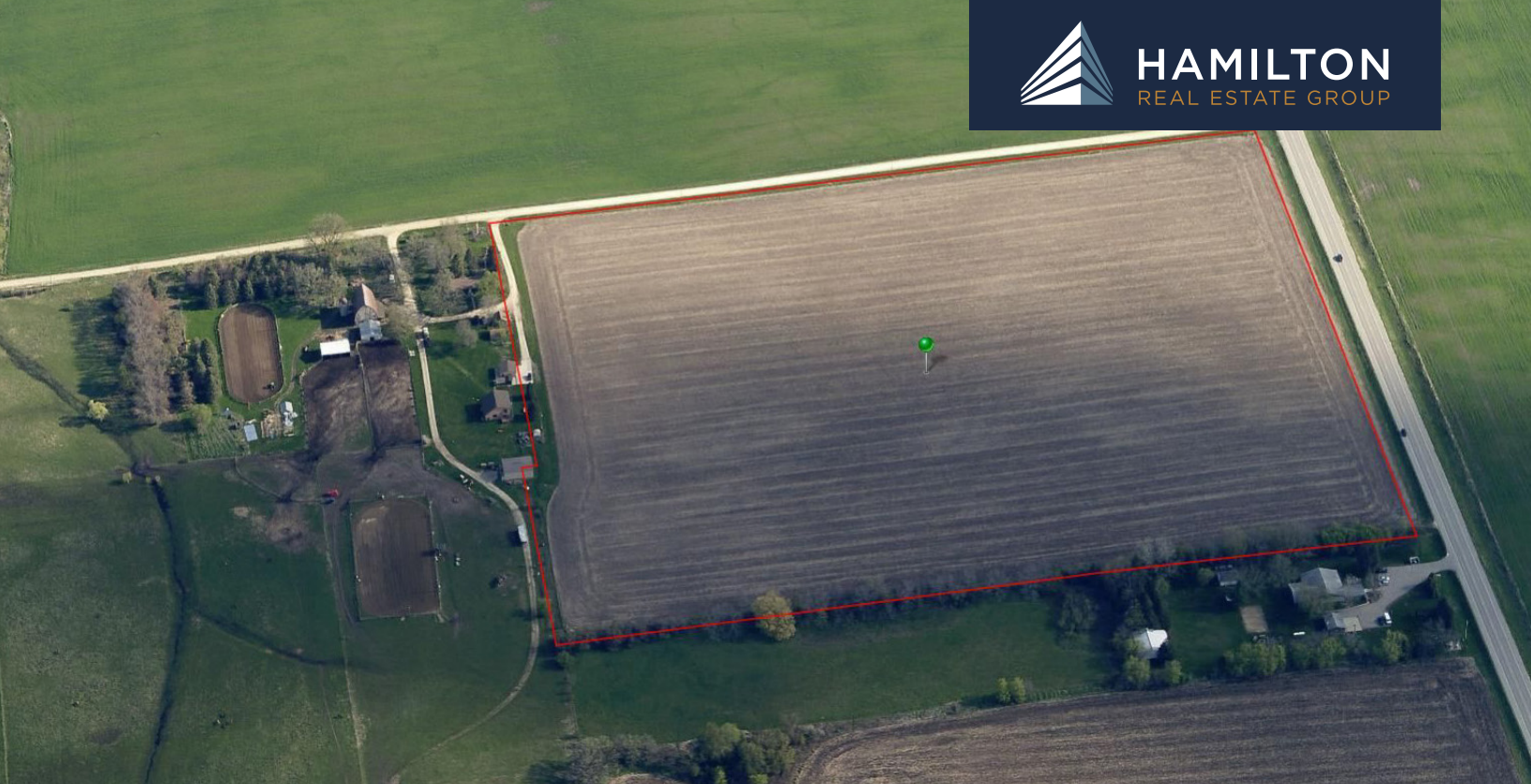

**HAMILTON**  
REAL ESTATE GROUP



# FOR SALE

## Residential and Development Land

County Road 8 at 42nd Street SW  
Rochester, Minnesota 55902

- 31.79 Acres of Residential and Development Land For Sale
- SW corner of County Road 8 (Bamber Valley Rd SW) and 42nd St SW
- This fantastic location is only 9 minutes from the world-class Mayo Clinic in Rochester, MN and just south of two of Rochester's most prestigious neighborhood developments, Mayowood Estates and Hart Farms.
- Solid investment property that is 6 minutes from countless desirable amenities including 2 large shopping centers anchored by Target, HYVEE, Macy's, and Scheels.
- Currently utilized as farmland
- Additional 80 acres of development land adjacent to property also available for sale

**PRICE: \$640,000**

**FOR MORE INFORMATION:**

[VISIT OUR WEBSITE](#)

### CONTACT

**Ari Kolas | Principal**

ari@hamiltonmnre.com

O: 507-281-1002 ext 103 | M: 507-271-5553

www.hamiltonmnre.com



## CONTACT

**Ari Kolas | Principal**

[ari@hamiltonmre.com](mailto:ari@hamiltonmre.com)

O: 507-281-1002 ext 103 | M: 507-271-5553

[www.hamiltonmre.com](http://www.hamiltonmre.com)